



दिल्ली विकास प्राधिकरण  
DELHI DEVELOPMENT AUTHORITY  
रोहिणी योजना कार्यालय  
ROHINI PROJECT PLANNING OFFICE

AREA STATEMENT

TOTAL AREA OF PLOT = 1632.99 SQ.M.

DETAILS OF PLOT :

PLOT NO.	USE	AREA (IN SQ.M.)
1	PARK	1613.64

NOTES:

1. THIS DRAWING IS BASED ON P.T. SURVEY SUPPLIED BY SURVEY UNIT OF ROHINI PLANNING OFFICE ON 14.06.2016.
2. DEVELOPMENT CONTROL NORMS ARE AS PER MPD-2021
3. ALL DIMENSIONS ARE IN METRES.
4. ONLY WRITTEN DIMENSIONS ARE TO BE FOLLOWED.
5. THE SCHEME WAS APPROVED IN THE 352TH SCREENING COMMITTEE MEETING HELD ON 21.07.2017 VIDE ITEM NO. 85.2017.

- ✿ EXISTING TREES
- ⊙ EXISTING DRY WELL
- ↑ EXISTING ELECTRIC POLE

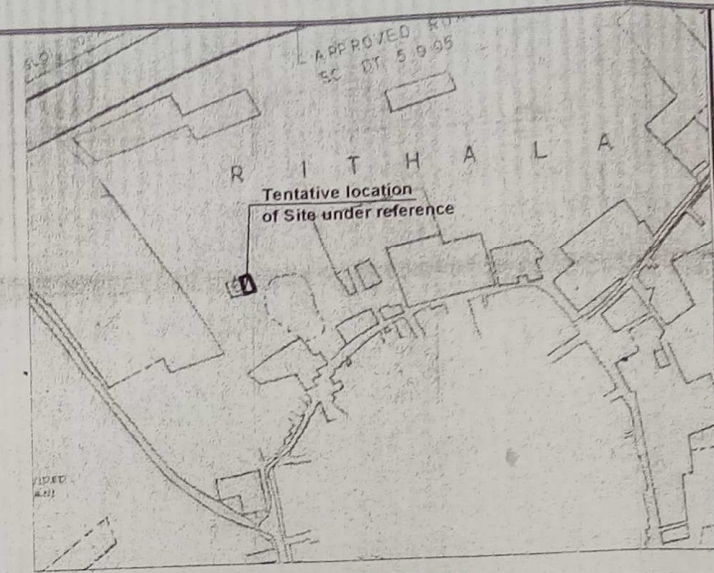

KEY PLAN

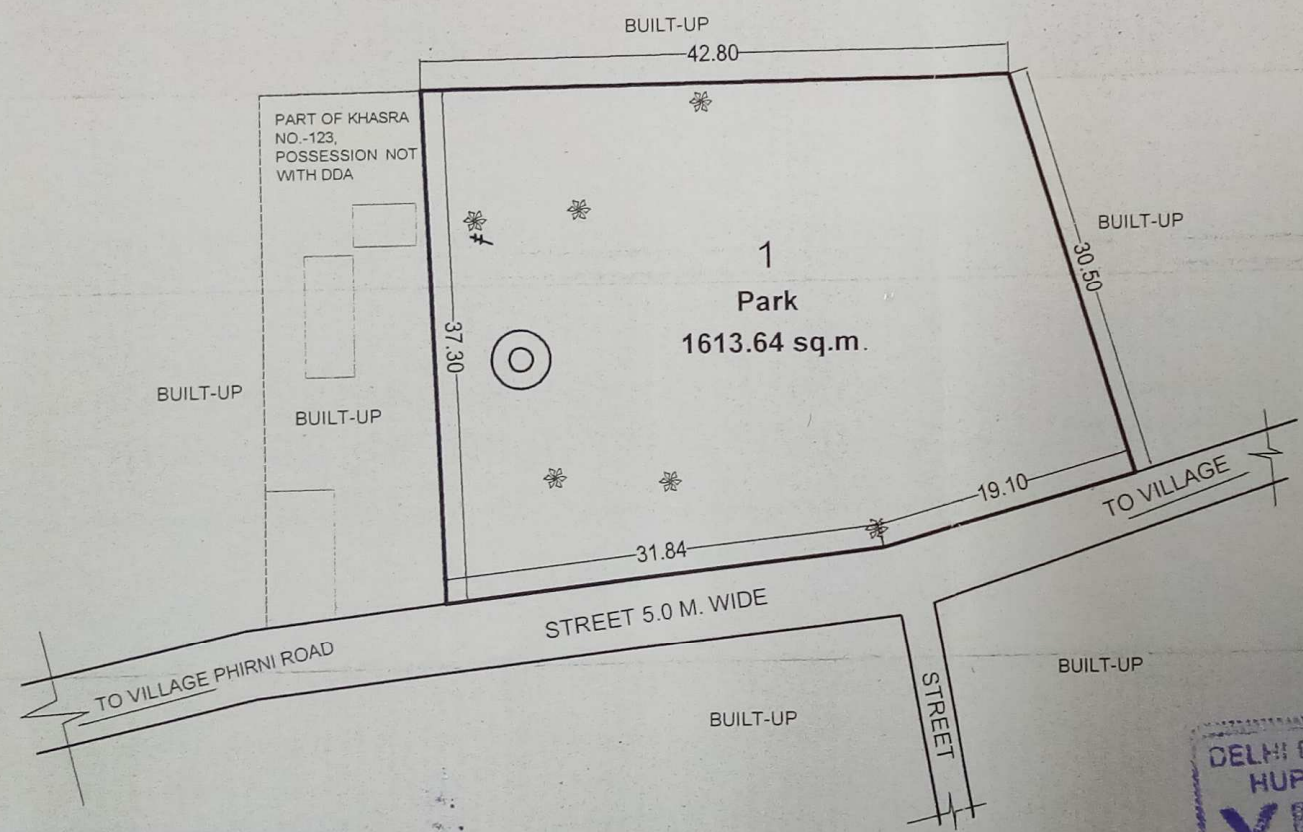

DELHI DEVELOPMENT AUTHORITY  
HUPW-CO-ORDINATION UNIT  
**VERIFIED**  
This proposal was considered in the  
352 Screening Committee  
Meeting held on 21/7/17  
Vide item No. 85.2017  
Dy. Director (Arch.) Co-ordn.

DELHI DEVELOPMENT AUTHORITY  
CERTIFIED  
Approved in 352nd Screening  
Committee Meeting Dt. 21.07.2017  
vide Item No. 85.2017  
Sign. H.K. Bharti  
Name H.K. Bharti  
Designation Dy. Cplg. Rohini  
Zone M & H (PF)

The Proposal has been approved by  
the 352nd Screening Committee  
held on 21.7.2017 vide item No. 85.2017  
in File No. PP/R/1003-5/2003/2005

DELHI DEVELOPMENT AUTHORITY  
HUPW-CO-ORDINATION UNIT  
**VERIFIED**  
This proposal was considered in the  
352 Screening Committee  
Meeting held on 21/7/17  
Vide item No. 85.2017  
Dy. Director (Arch.) Co-ordn.

FILE No: PP/R/1003-5/2003/2005  
LAYOUT PLAN OF PARK AT KHASRA NO.-123 IN  
VILLAGE RITHALA, SECTOR-V, ROHINI, PHASE-I & II  
SCALE 1:500  
DATE JUNE 2017  
PLG ASST. ASSTT DIR. (PLG.) (ON CONTRACT)  
ASSTT DIR. (PLG.)  
DY DIR. (PLG.)  
DIRECTOR (PLG.)  
रोहिणी  
ROHINI  
योजना कार्यालय नई दिल्ली 110085  
PLANNING OFFICE, NEW DELHI 110085  
DRG NO. 16/PARK/04/NO-123A

A.K. Malhotra  
DY. DIR. (PLG.)  
Savita Mangla  
ASSTT. DIR. (PLG.)  
Chopra Shakuntala  
PLG. ASSTT.