

DELHI DEVELOPMENT AUTHORITY
HUPW-CO-ORDINATION UNIT
VERIFIED
This proposal was considered in the
353rd Screening Committee Meeting
Meeting held on 28.09.2017
Vide Item No. 97.2017
Dy. Director (Arch.) Co-ordn.

DELHI DEVELOPMENT AUTHORITY
CERTIFIED
Approved in 353rd Screening
Committee Meeting on 28.9.2017
vide Item No. 97.2017
Sign: H. S. BHARTI
Designation: DIR.(PLG.)R

The Proposal has been approved by
the 353rd Screening Committee
held on 28.9.17 vide item No. 97.2017
in File No. DIR.(PLG.)R/5037/PKT 1/BLK-B/2017

PLG. ASSTT. Asstt. Director (PLG.) Dy. Director (PLG.)
24/10/17 24/10/17 24/10/17

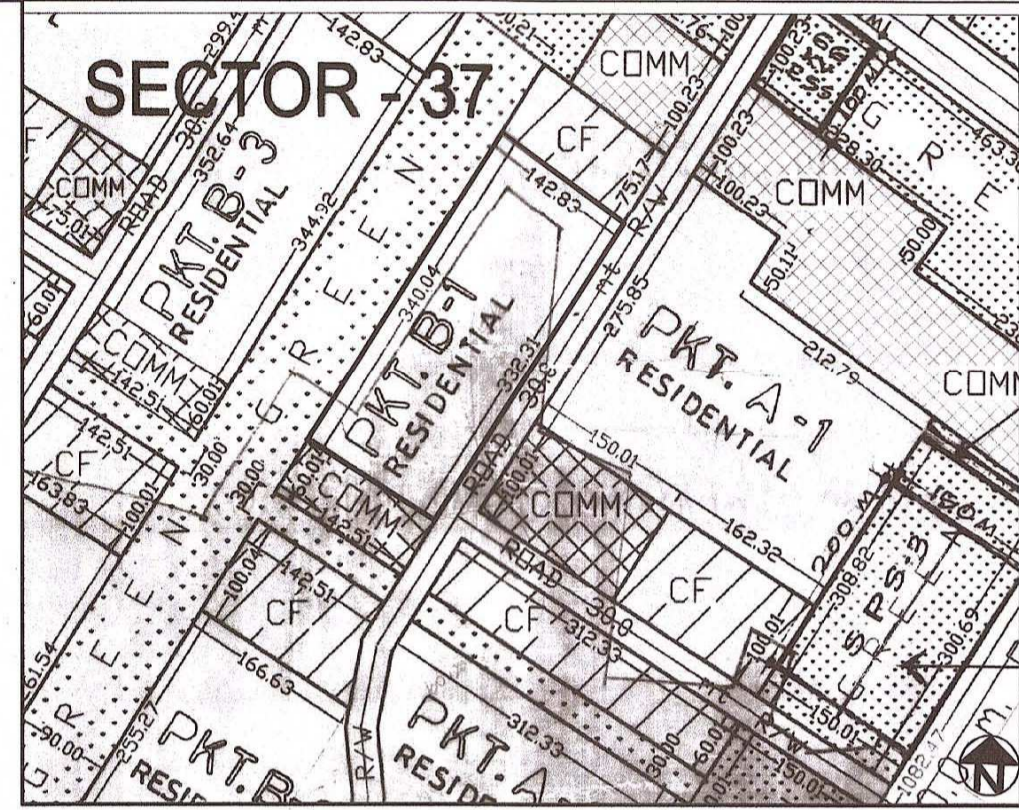

दिल्ली विकास प्राधिकरण
DELHI DEVELOPMENT AUTHORITY
रोहिणी योजना कार्यालय
ROHINI PLANNING OFFICE

AREA STATEMENT

- A. TOTAL AREA OF POCKET 4.21 HA.**
- AREA UNDER BUILT-UP 0.90 HA.
 - NET AVAILABLE AREA OF POCKET 3.31 HA.

B. AREA BREAK UP

USE	PROPOSED AREA	
	AREA (IN HA.)	AREA (IN %)
RESIDENTIAL PLOTS	1.10	33.41
PARKS/ GREEN AREA	0.83	24.81
UTILITIES (MB/VB, DHALAO & ESS)	0.05	1.56
CIRCULATION (INCLUDING 2.0 M. WIDE PATHWAY)	1.33	40.22
TOTAL	3.31	100

C. DETAIL OF PLOTS

PLOT AREA (IN SQ.M.)	PLOT SIZE (IN SQ.M.)	PLOT NUMBERING	TOTAL PLOTS	AREA UNDER PLOTS (IN SQ.M.)	NUMBER OF DU'S	POPULATION
60	5 X 12	1-59, 88-93, 96-101, 104-109, 112-117	83	4980	332	1494
32	4 X 8	60-86, 119-143, 168-207, 232-271	132	4224	396	1782
26	3.25 X 8	145-154, 157-166, 209-218, 221-230	40	1040	120	540
66	5.5 X 12 (ODD PLOTS)	87, 94, 95, 102, 103, 110, 111, 118	8	528	32	144
34	4.25 X 8 (ODD PLOTS)	144, 155, 156, 167, 208, 219, 220, 231	8	272	24	108
TOTAL			271	11044	904	4068

- NET RESIDENTIAL DENSITY FOR PLOTTED POCKET ONLY = 273 DU'S/ HA., 1229 PPH.
- DEVELOPMENT CONTROL NORMS AS PER MPD-2021.

NOTE:

- THIS PLAN IS PREPARED BASED ON THE TOTAL STATION SURVEY(TSS) PROVIDED BY ENGINEER WING, RPD-6, DDA.
- TREE SHOWN IN DRAWING NEAR PLOT NO. 103 & 112 ARE TO BE CONSIDERED AS PER PREVAILING POLICY DURING EXECUTION BY ENGINEERING WING.
- EXISTING ROAD PASSING THROUGH THE POCKET IS TO BE ABANDONED ONCE THE PROPOSAL FOR PLOTTED DEVELOPMENT IS EXECUTED AT SITE.
- THE UTILITIES COMPRISES OF DHALAO, MB/VB ARE PROVIDED AS PER MPD-2021
- TWO NUMBER OF 11KV ESS MEASURING 80 SQ.M. (8 M.X10 M.) ARE PROVIDED IN THE POCKET. AREA AND NUMBER OF ESS MAY BE ALTERED ACCORDING TO THE FUTURE REQUIREMENT.
- THE OTHER FACILITIES LIKE MCH, CSC, UGR WILL BE PROVIDED IN THE NEAR BY FACILITY POCKET.
- BOUNDARY WALL AROUND THE RESIDENTIAL PLOTTED POCKET BE ERCTED TO PROTECT THE LAND AND TO PREVENT ANY MISSUSE IN FUTURE BY ALLOTIES.
- ALL DIMENSIONS ARE IN METRES.
- ONLY WRITTEN DIMENSIONS ARE TO BE FOLLOWED.
- ENGG. WING TO CHECK AND VERIFY THE DIMENSIONS BEFORE EXECUTION AT SITE. DISCREPANCY IF ANY MAY BE BROUGHT TO THE NOTICE OF DIR.(PLG.) ROHINI OFFICE.
- THE PROPOSAL AS REFLECTED IN AGENDA WAS APPROVED IN THE 353rd SCREENING COMMITTEE MEETING HELD ON 28.09.2017 VIDE ITEM NO. 97.2017

LEGEND:

- ODD PLOTS
- PARKS/GREEN AREA
- TREE

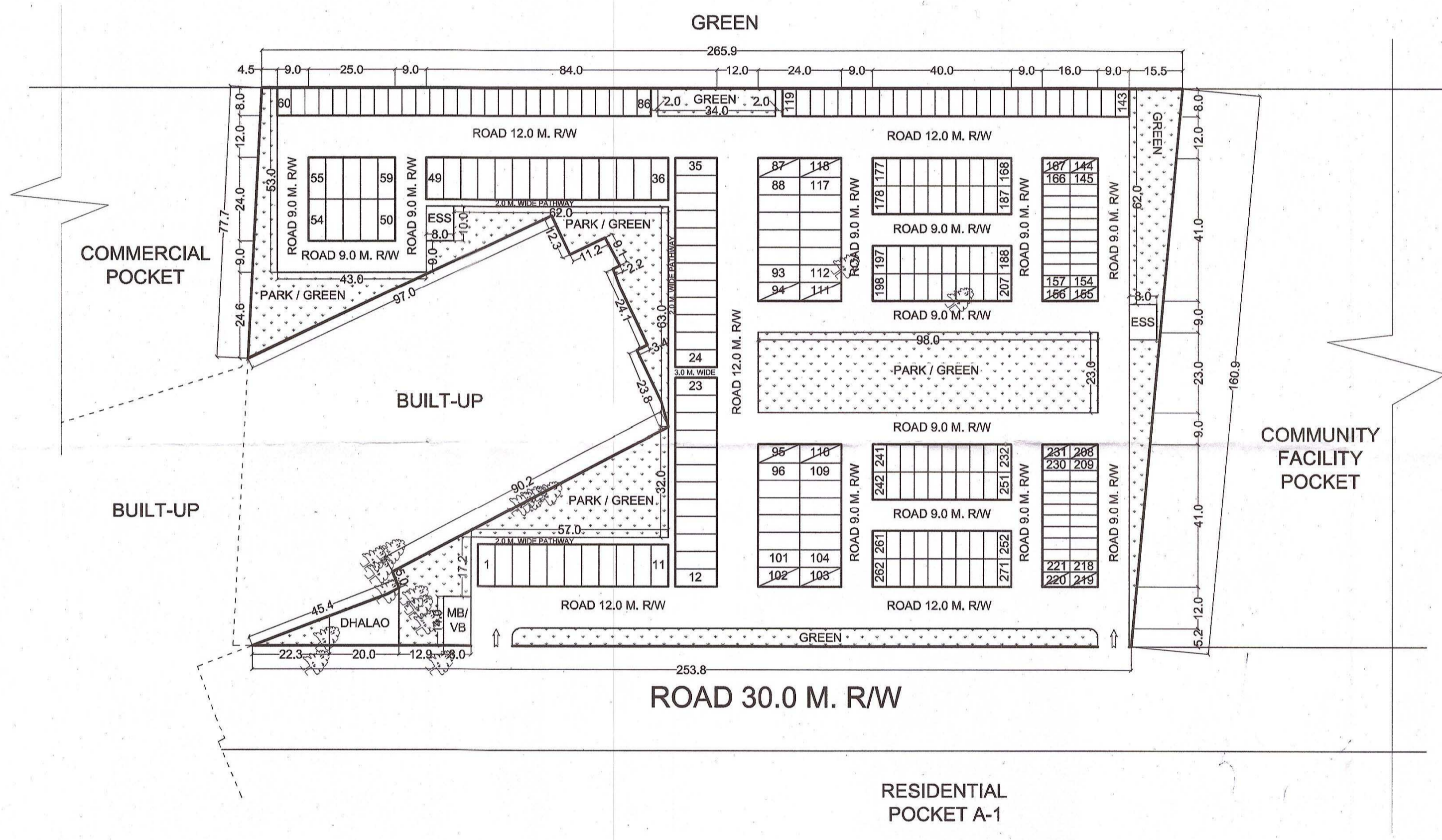

FILE No: DIR(PLG)R/5037/PKT.-1/BLK.-B/2017

LAYOUT PLAN OF RESIDENTIAL POCKET-1, BLOCK-B, SECTOR-37, PHASE-V, ROHINI

माप SCALE 1:1000
तारीख DATE AUGUST 2017

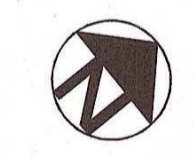

योजना सहायक/ PLG. ASSTT. [Signature] सहायक निदेशक (योजना) ASSTT. DIR.(PLG.) (ON CONTRACT) [Signature]

सहायक निदेशक (योजना) ASSTT. DIR. (PLG.) [Signature]

उप निदेशक (योजना) DY. DIR. (PLG.) [Signature]

निदेशक (योजना) DIRECTOR (PLG.)

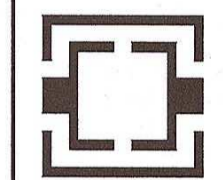

रोहिणी ROHINI
योजना कार्यालय नई दिल्ली 110085
PLANNING OFFICE, NEW DELHI 110085

डाईग संख्या : DRG. NO. 1