

Details regarding plot size, development control norms, set backs:-

Plot No.	Area (sq.m)	Proposed to be Sub-divided	Area in sq.m
9	2080	(i) 9-A (ii) 9-B (iii) 9-C	500 (20 X 25 m) 500 (20 X 25 m) 1080 (27 X 40 m)

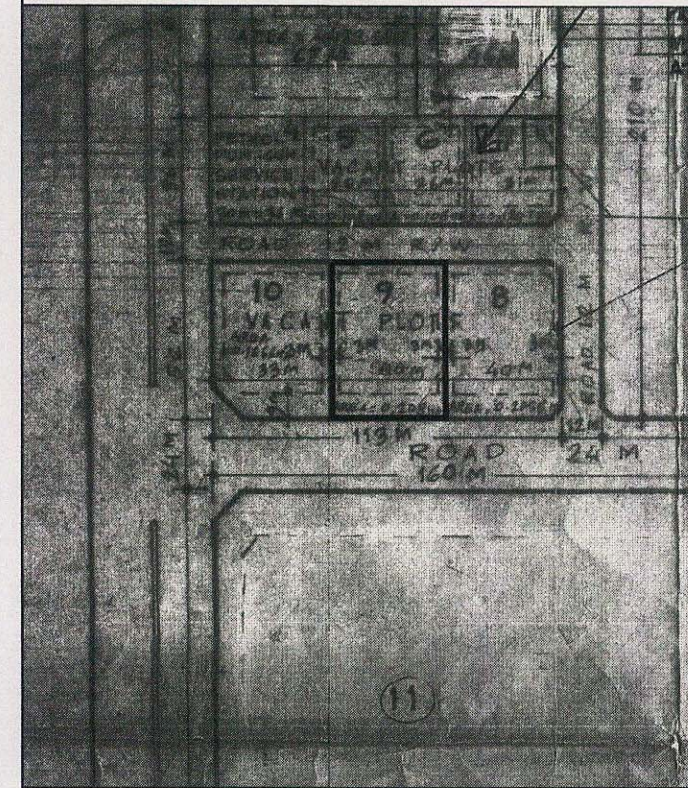

SITE PLAN

Sl. No	Set backs				Development Control norms
	Front (m)	Rear (m)	Side (m)	Side (m)	
(i) 4	3	3	-	-	For plot no. 9-A & 9-B i.e. 500 sq.m. as per MPD 2021 norms for smaller plots.
(ii) 4	3	3	-	-	
(iii) 6	3	3	3	3	For plot no. 9-C As per MPD-2021 norms.

NOTES:-

- DO NOT SCALE THE DRAWING. WRITTEN DIMENSIONS TO BE FOLLOWED.
- IN CASE OF ANY DISCREPANCY THE SAME BE BROUGHT TO THE NOTICE OF DIR. (PLG) NARELA.
- NECESSARY PERMISSION SHALL BE TAKEN FROM THE CONCERNED DEPARTMENT FOR CUTTING OF TREES.
- MASTER PLAN FILE NO. FOR SECTOR A-7 NARELA IS F3(34)2010/MP.

NOTE:-

APPROVED BY 303rd SCREENING COMMITTEE HELD ON 21.12.2011 VIDE ITEM NO. 113:2011 IN FILE NO. F3(34)2010/MP

To Narela Village

ROAD 40 M R/W

To UER-I (80 M R/W) Road

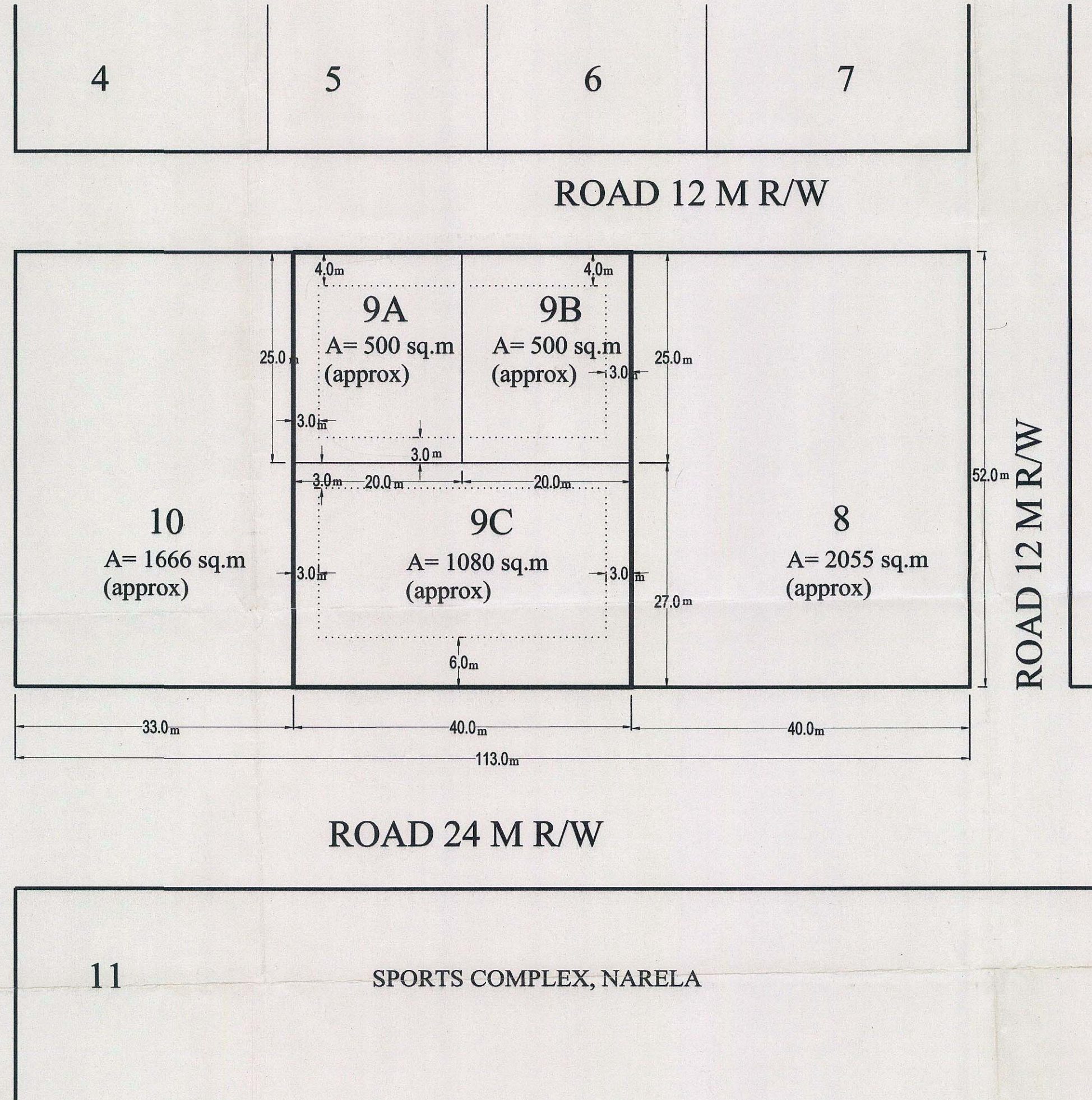

DELHI DEVELOPMENT AUTHORITY
Approved in 303rd Meeting Held on 21.12.2011 Item No. 113:2011
Director (Plg.)

DELHI DEVELOPMENT AUTHORITY
HUPW CO-ORDINATOR
VERIFIED
This proposal was considered by 303rd Screening Committee Meeting held on 21.12.2011 vide Item No. 113:2011
By Director (Arch.) Coord

PART PLAN OF LOP, SECTOR A-7, NARELA

SUB-DIVISION OF PLOT NO. 9, PUBLIC & SEMI PUBLIC FACILITY AREA, SECTOR A-7 (FA-2), NARELA

SCALE 1:500

5m 10m 20m			DRAWING NO.
PLG ASST	ASST. DIR	JOINT. DIR. (PLG)	NORTH
54/-	54/-	54/-	
DIRECTOR (PLG)	ADDL. COMM. (PLG.) UE & P	COMMISSIONER (PLG)-II	

NARELA PROJECT