

DELHI DEVELOPMENT AUTHORITY ROHINI PROJECT PLANNING AND DESIGN

THE DISTANCE FROM 30M ROAD OF GREEN UP TO 66KV ESS IS 90M. THE SAME IS APPROVED BY COMM. (PLG.) ON 28-6-2013 IN FILE NO. PPR/4001/2002 AT PAGE NO. 32/N AND 210/C.

THE 66KV ESS SITE OF SIZE 85.5M X 100.0M IN SECTOR-30 IS APPROVED IN THE 260TH S.C. MEETING HELD ON 5-10-2007 VIDE ITEM No. 149: 2007 IN FILE No. PPR/4001/DH-IV-V/ESS/PT/2006.

THE ESS SITE IS AUTHENTICATED BY DY. DIR. (ARCH.) COORDINATION Dt. 20-11-07 IN FILE NO. PPR/4001/PH-IV-V/ESS/PT/2006

CNG SITE (36.0M X 30.0M)
THE SITE HAS BEEN APPROVED IN 273RD SCREENING COMMITTEE MEETING HELD ON 2-1-09 VIDE ITEM No. 02:2009 AND THE APPROVAL CERTIFIED BY DIR. (PLG.) R.D. 5-3-09 AND VERIFIED BY DY. DIR. ARCH. (COORDN.) HUPW Dt. 23-3-09 IN FILE NO. DIR. (PLG.) R/1061/PT-2009

LANDUSE AREA STATEMENT

A. TOTAL AREA OF SECTOR 30 **164 HAC**
B. LANDUSE BREAKUP OF AREA UNDER SECTOR 30

LANDUSE	AREA (HAC)	PERCENTAGE	AREA STATEMENT
RESIDENTIAL (GROSS)	94.5	57.6	TOTAL AREA OF POCKET GH-3, BLOCK-B - 4.49M HA. AREA UNDER GROUPOUSING POCKET GH3(A) - 2.200 HA. (PROPOSED FOR RATYA SABHA SECRETARIAT OFFICERS AND STAFF HOUSING ACCOMMODATION (21 BRANCH FILE NO. F-32(14)/2010/11/1000)
COMMERCIAL	12.0	7.3	AREA UNDER GROUPOUSING POCKET GH3(B) - 2.294 HA. (PROPOSED FOR D.P.O. RESIDENTIAL ACCOMMODATION (11 BRANCH FILE NO. F-32(194)/04/11)
PUBLIC / SEMI-PUBLIC	20.0	12.2	
RECREATIONAL	23.5	14.3	
CIRCULATION	14.0	8.6	
TOTAL	164	100	

C. LANDUSE BREAKUP OF GROSS RESIDENTIAL AREA

LANDUSE	AREA (HAC)	PERCENTAGE
RESIDENTIAL (NETT)	53.5	56.6
COMMERCIAL	3.0	3.2
EDUCATIONAL, HEALTH AND OTHER FACILITIES	13.0	13.8
RECREATIONAL	12.5	13.2
CIRCULATION	12.5	13.2
TOTAL	94.5	100

D. DISTRIBUTION OF NET RESIDENTIAL AREA

	NET AREA (HAC)	DUs	PERCENTAGE	POPULATION
1. GROUP HOUSING	16.4	3000	30.7	15000
2. PLOTTED HOUSING (LIG, MIG AND OTHERS)	37.1	6400	69.3	32000
TOTAL	53.5	9400	100	47000

E. TOTAL NO. OF PROPOSED DUS IN SECTOR 30 **9400 DUS**
F. TOTAL NO. OF PROPOSED PLOTS **3200**
G. TOTAL NO. OF PROPOSED FLATS **3000**
H. TOTAL PROPOSED POPULATION FOR SECTOR 30 **47000**

LEGEND

	RESIDENTIAL		PUBLIC & SEMI PUBLIC FACILITIES
	COMMERCIAL		RECREATIONAL

NOTE: ALL DIMENSIONS ARE IN METER
DISTANCE BETWEEN THE OFFSET AT CURVED ROADS IS 50M

LAYOUT PLAN OF SECTOR 30, PHASE IV, ROHINI IS APPROVED IN 219 SCREENING COMMITTEE VIDE ITEM No. 17:2002 IN FILE No. PPR/4030/2002 DATED 2/7/2002

LAYOUT PLAN OF SECTOR 30, PHASE IV, ROHINI

DATE:	SCALE: 1:5000
PLG. ASST.	
ASST. DIR.	
ASHOK BHATTACHARJEE JT. DIR (PLG.)	
KULDEEP RAJ	

PHASE - V

1000SQM (APP) PLOT RESERVED FOR COMMON PARKING FOR PKT-1 SECTOR 30

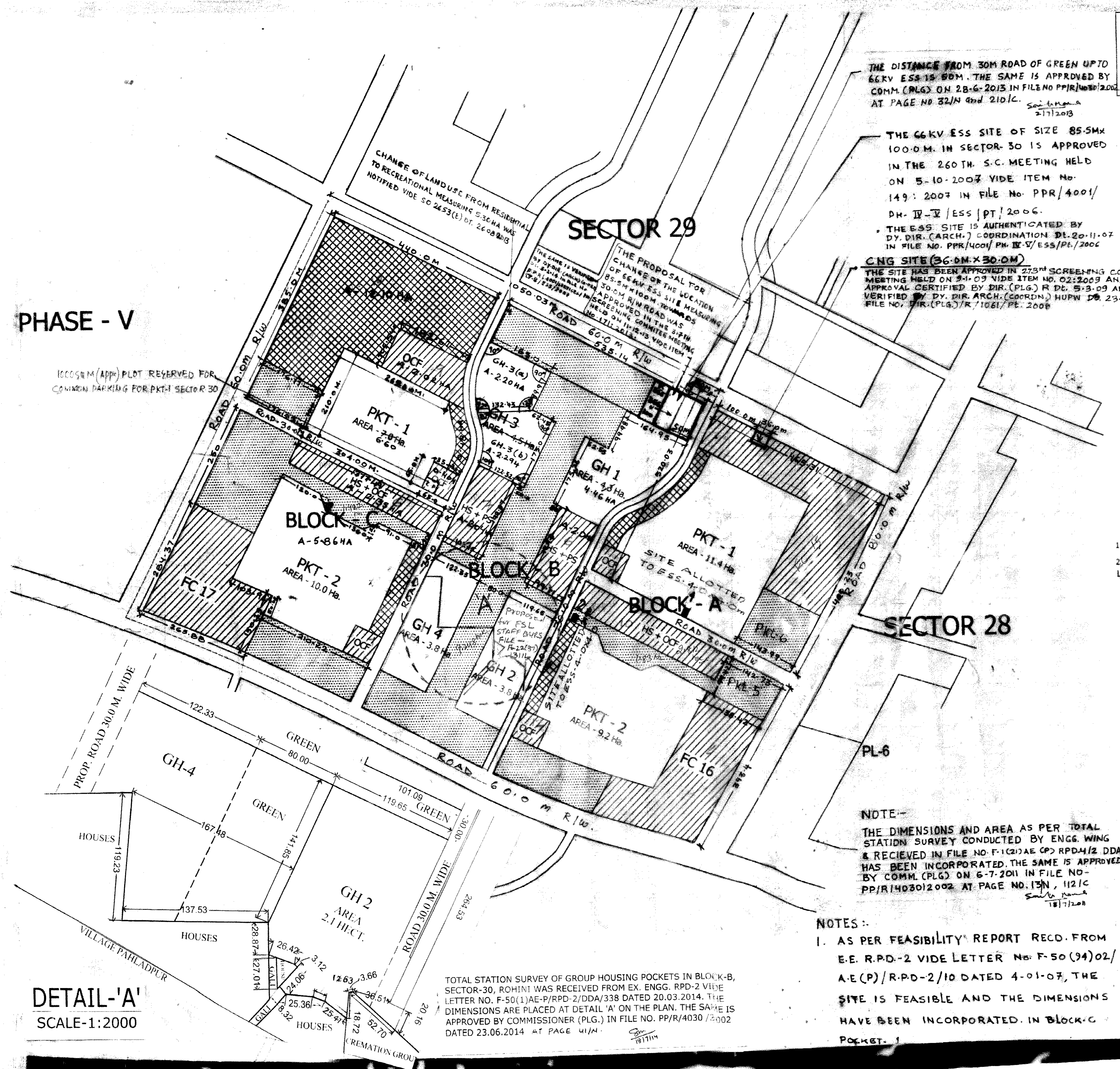

TOTAL STATION SURVEY OF GROUP HOUSING POCKETS IN BLOCK-B, SECTOR-30, ROHINI WAS RECEIVED FROM EX. ENGG. RPD-2 VIDE LETTER NO. F-50(1)AE-P/RPD-2/DDA/338 DATED 20.03.2014. THE DIMENSIONS ARE PLACED AT DETAIL 'A' ON THE PLAN. THE SAME IS APPROVED BY COMMISSIONER (PLG.) IN FILE NO. PPR/4030/2002 DATED 23.06.2014 AT PAGE 41/M.

NOTES:
1. AS PER FEASIBILITY REPORT RECD. FROM E.E. RPD-2 VIDE LETTER No. F-50 (94)02/A.E(P)/R.PD-2/10 DATED 4-01-07, THE SITE IS FEASIBLE AND THE DIMENSIONS HAVE BEEN INCORPORATED IN BLOCK-C POCKET-1

DETAIL-'A'
SCALE-1:2000

THE ESS SITES HAVE BEEN AUTHENTICATED BY DY. DIRECTOR (ARCH.) ON 27-2-09 AT PAGE 7/N VIDE FILE NO. PPR/4001/SERVICE PH IV V/ESS

ESS NO. 192 MEASURING 4.0M X 4.0M APPROVED IN 244TH SCREENING COMMITTEE VIDE ITEM NO 132:2005 DT. 16-12-05 IN FILE NO. PPR/4001/SERVICE PH IV V/ESS