

**SECTOR AREA 25**  
 ROAD NO. 143

USE OF LAND

RESIDENTIAL	
COMMERCIAL	14.14
EDUCATIONAL	5.60
PLAY GROUND	14.38
CUMULATIVE	67.8

REQUIREMENTS OF FACILITIES

LOCAL SHOPPING	0.75 HA
CHILDREN'S PLAY AREA	0.75 HA
PRIMARY SCHOOL	0.60 HA
MIDDLE SEC. SCHOOL	1.60 HA
PARKS - PLAY GROUND	



S.N.	PLOT NO.	SIZE	DATE OF PLAN
1	03	18.0 X 13.50	2-03-95
2	04	8.0 X 10.0	8-03-94
3	11	18.0 X 30.0	8-03-94
4	7	13.5 X 18.0	8-03-94
5	24	18.0 X 0.0	8-03-94
6	51	12.5 X 3.0	8-03-94
7	10	8.0 X 10.0	8-03-94

**LAYOUT PLAN**

**25**  
 DATE OCT 19 2012

CNG SITE (45.0M X 33.0M) IS APPROVED IN THE 300<sup>TH</sup> SCREENING COMMITTEE MEETING HELD ON 8-8-2011 VIDE ITEM NO. 53/2011 WITH THE CONDITION THAT THE EARLIER APPROVED LOCATION BE RETAINED THE AREA OF SERVICES TO BE MAINTAINED AS PER THE TERMS FROM CONSTRUCTION BY ALLOTTEE IN FILE NO. DIR/PLG/R/11061/PT/03

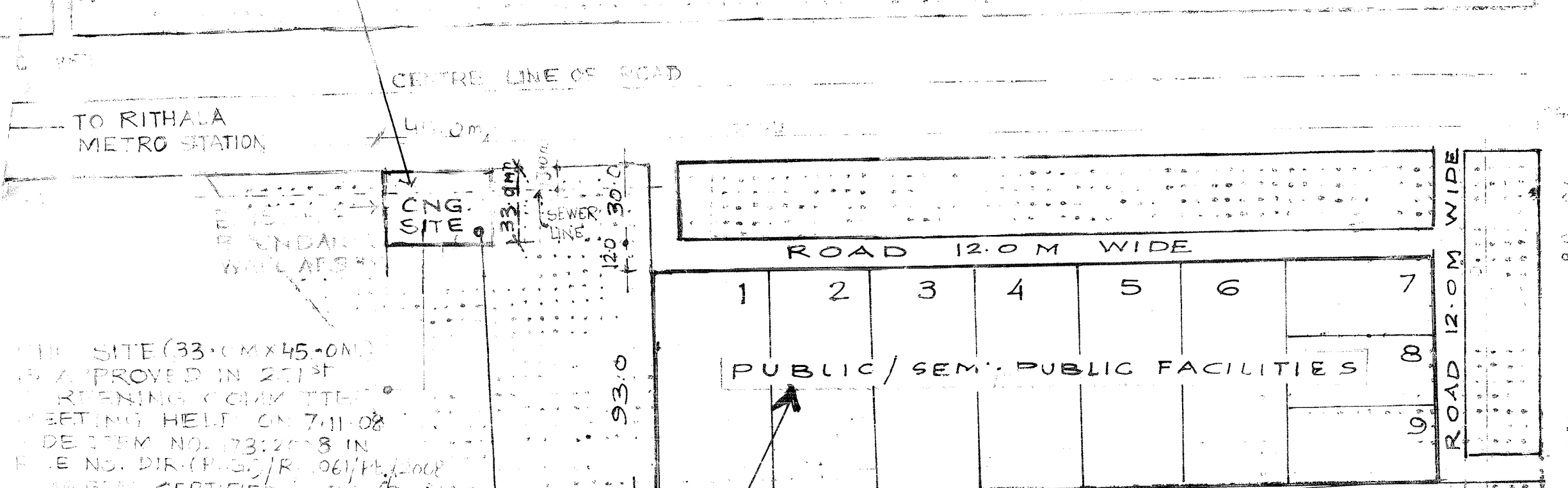

FOR DETAIL REFER MODIFIED LAYOUT PLAN FOR P.S.R FACILITIES APP. BY COMM. (PLG.) ON 14.12.2009 IN FILE NO. PP/R/2080/2000/PT



APPROVED BY COMM. (PLG.) DT. 5-6-99 VIDE FNO. PP/R/3025/11/99

THIS DRAWING HAS BEEN APP'D. IN THE SCREENING COMMITTEE MEETING HELD ON 8-8-2011 VIDE ITEM NO. 53/2011 ALLOTMENT OF LAND MEASURING 1465 SQ.M. AT BHAGWAN MAHAVIR ROAD, SEC. 25, ROHINI, NEW DELHI FOR C.N.G. SERVICE STATION IN FILE NO. F-13(18)/2008/C.L/PP/CN 5/11 DATED: 24-2-2012.

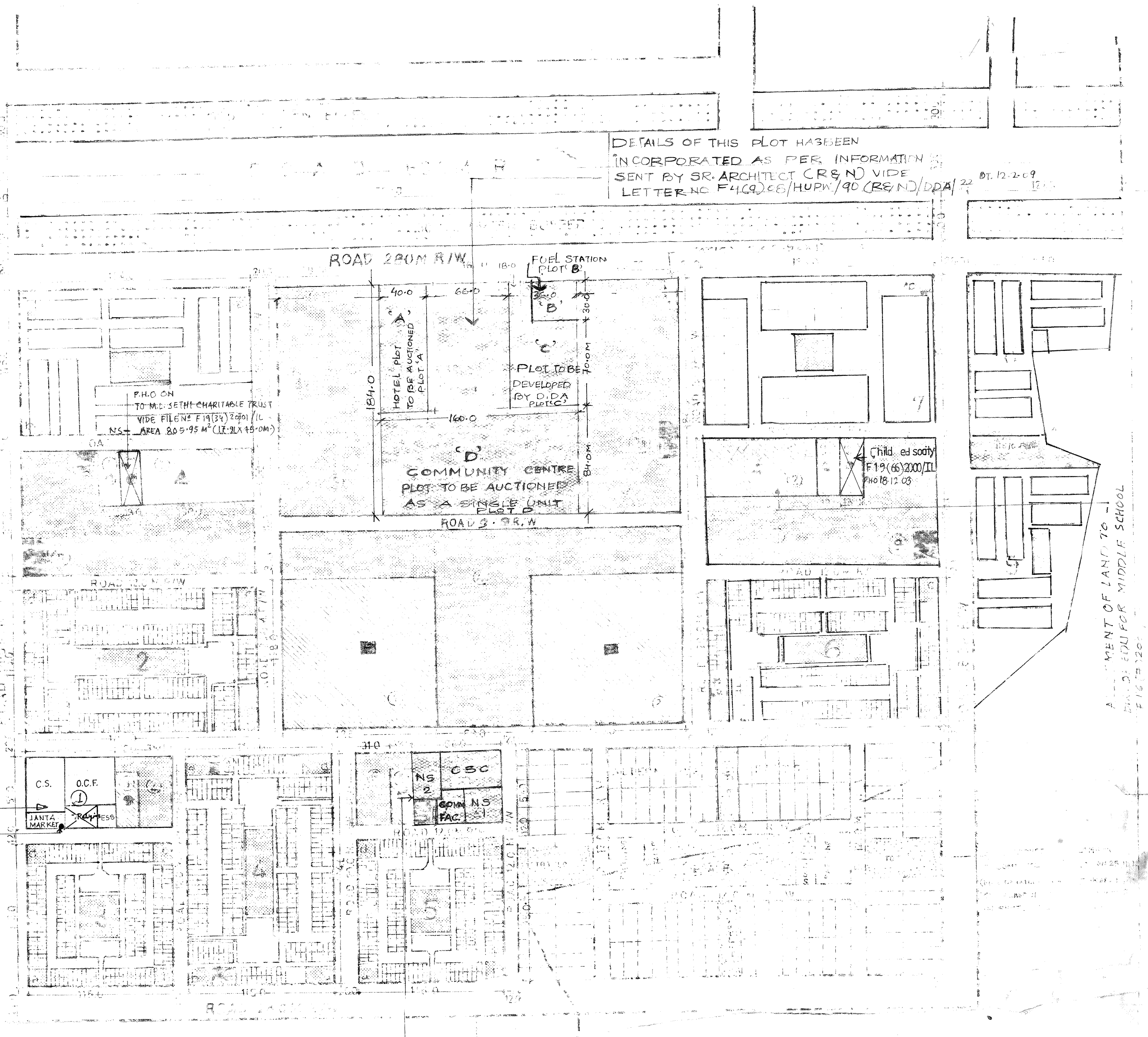

THIS DRS IS APPROVED IN 225<sup>TH</sup> SCREENING COMMITTEE HELD ON 24-12-03 VIDE ITEM NO. 143/2003

SECTOR-25