

AREA OF SECTOR	69.91 AC.
RESIDENTIAL POCKET INCLUSIVE OF EXCESS ROADS & INTERNAL OPEN SPACES	38.600 60.41
PLANNED GROUP HOUSING	5:29
FACILITIES	11:65 18.65
EDUCATIONAL	
HR. SEC. SCHOOL NS / PS	3:55 2:02
COMMERCIAL	
COMMUNITY CENTRE	1:22 2:32
RECREATION	
PARK	2:00
CROQUET TENNIS	13:59 20:91
ROAD 13.5 M R/W	8:42
ROAD 18.0 M R/W	4:97

- MANAGED PUR. MOTOR
- E.S. (13.5 X 18.0)
- SWITCHING STN. (18.0 X 30.0)
- POCKETS NOT INCLUDED IN THE CIV. DRAW
- OLD POCKET NO.

1. ALL D.U.S. FOR E.W.S. & L.I.G. ARE TWO STORE BUILDINGS.
 2. FOR DETAIL OF POCKET REFER POCKET LAYOUT.
 3. THIS PLAN SHOWS KEYS ALL THE PLANS REFERED EARLIER.
 4. FOR DEMARCATION OF PLOTS REFER BLOTTED PLAN.

PLAN REVISED AS PER DECISION IN THE MEETING WITH V.C. DCA ON 11.12.82.

- NOTES:
1. THE AREA OF AVERAGE DEPTH 20 METERS AS CONCEDED BY THE GOVT. IN FILE NO. F-187(1) DATED 14.12.82.
 2. THE PLAN WAS SENT BY EX. ENCL. NO. 111/11/4400-02 DATED 14.12.82.
 3. LOCATION OF E.S. NO. 3 SHOWN AS PER LETTER NO. 111/11/4400-02 DATED 23.9.82.

DISTRIBUTION OF PLOTS & CROSS SECTION

BLOCK NO.	NO. OF PLOTS	NO. OF HOUSES
A	168	168
B	168	168
C	168	168
D	168	168
E	168	168
F	168	168
G	168	168
H	168	168
I	168	168
J	168	168
K	168	168
L	168	168
M	168	168
N	168	168
O	168	168
P	168	168
Q	168	168
R	168	168
S	168	168
T	168	168
U	168	168
V	168	168
W	168	168
X	168	168
Y	168	168
Z	168	168
TOTAL	496	496

LAYOUT PLAN OF SECTOR II

DATE 23.9.82

SCALE 1:200

ARCHITECT

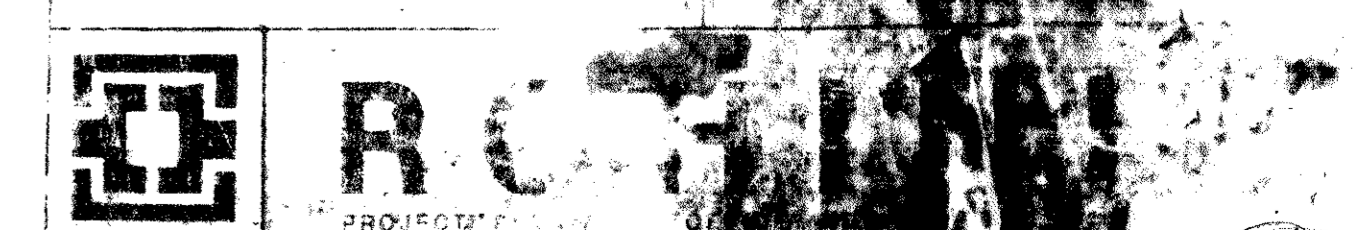

OCF PKT PROPOSED FOR ALLOTMENT TO S.S. JAIN SABHA VIDE FILE NO. F-7A (50) 2000/IL FOR RELIGIOUS PURPOSE AS PER THE NORMS OF MPD 2001.

OCF PKT PROPOSED FOR ALLOTMENT TO 'TARUWAR' VIDE FILE NO. F-4 (2) 2002/IL FOR RELIGIOUS PURPOSE AS PER THE NORMS OF MPD 2001.

RITHALA SEWAGE TREATMENT PLANT

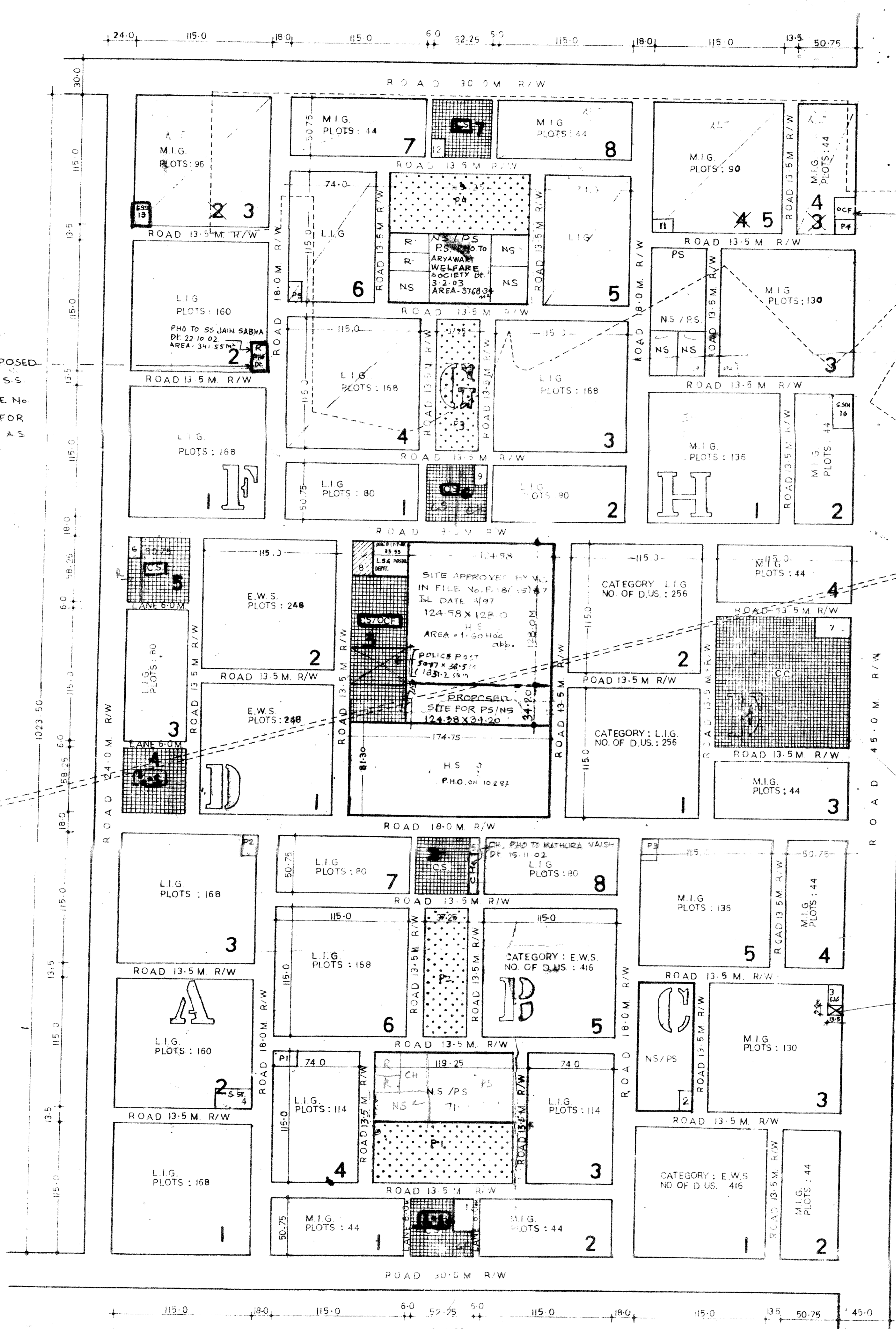

OCF PKT IS HANDED OVER TO (S.S. JAIN SABHA) ADARSH MANAV KALYANI SANSTHAN FOR RELIGIOUS PURPOSE ON 08-12-02 VIDE FILE NO. F-8(2)2001/IL.

3/ST - 1, 4, 8 & 10 - 60' X 100' (60' X 30.0 M)
 ALL OTHER SUB STATION SIZES 45' X 60' (13.5 X 18.0 M)
 NOTE: LOCATION OF E.S. IS MARKED ON THE BASIS OF LETTER NO. XEN (PLG) 2/6/2 (R. 18/2) DATED 24/2/80 (R. 18/2) 24/2/80 DATED 30-3-80.
 CORRECTIONS MADE AS PER REPRESENTATIVE REPORT SUBMITTED ON XEN (PLG) 2/6/2 (R. 18/2) DATED 24/2/80.
 DRAWN BY: [Signature]